

COUNTAXTM

SERVICE BULLETIN

15-T6-19

DATE: 29\04\2015

MODELS CONCERNED:

All MK4 B, C, F & T Series Tractors.
B Series B60-4TRAC, B250-4TRAC, C50, C60, C80, F60-4TRAC, F250-4TRAC, T50, T60 & T80.

CONCERN:

The Mk4 C Series parts lists do not show all the items required to correctly install the steering column in the bottom bearing.

In some instances the wrong hardware may have been installed in the bottom of the steering column on the Mk4 C series 2WD & 4WD tractors.

On all new product before sale and on any product presented for normal service it is essential an inspection is performed to ensure the correct hardware is installed and tightened correctly.

- 1) In order to check the column fixing safe access is required to the underside of the machine. Please remove the deck and isolate the machine according to the standard Countax service procedure.
- 2) Please locate the M8 steering column fixing on the underside of the chassis as shown in fig A below.

Fig A

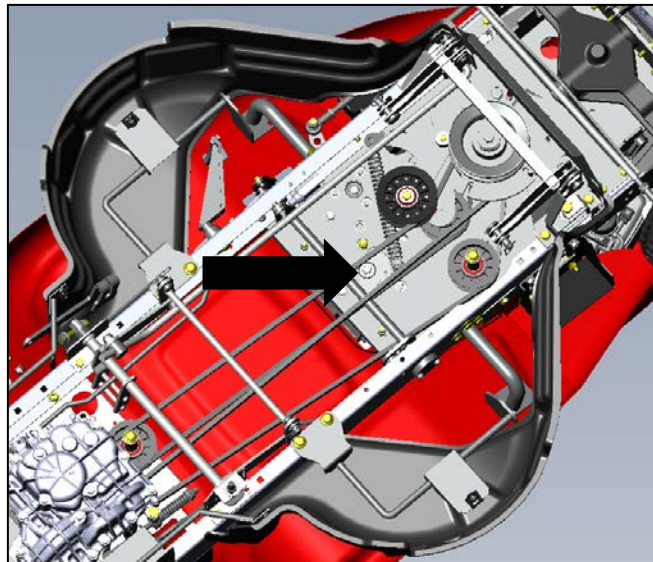

- 3) Remove using a 13mm socket.
- 4) Once removed measure the length of the M8 Hex Head Flange Screw and check it measures 16mm as shown in fig B.

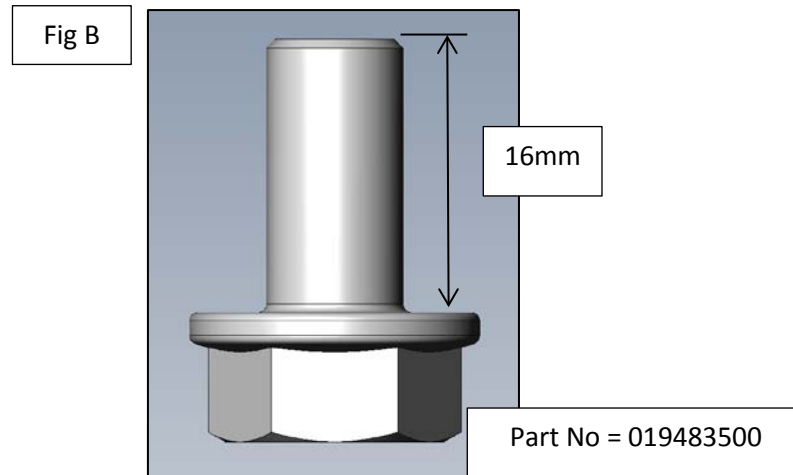

- 5) Also ensure the washers are correct as per the descriptions & numbers shown in fig C below. The shakeproof washer should be replaced with a new one before re-assembling. If the parts removed do not match then all the parts should be replaced to match the assembly in fig C.

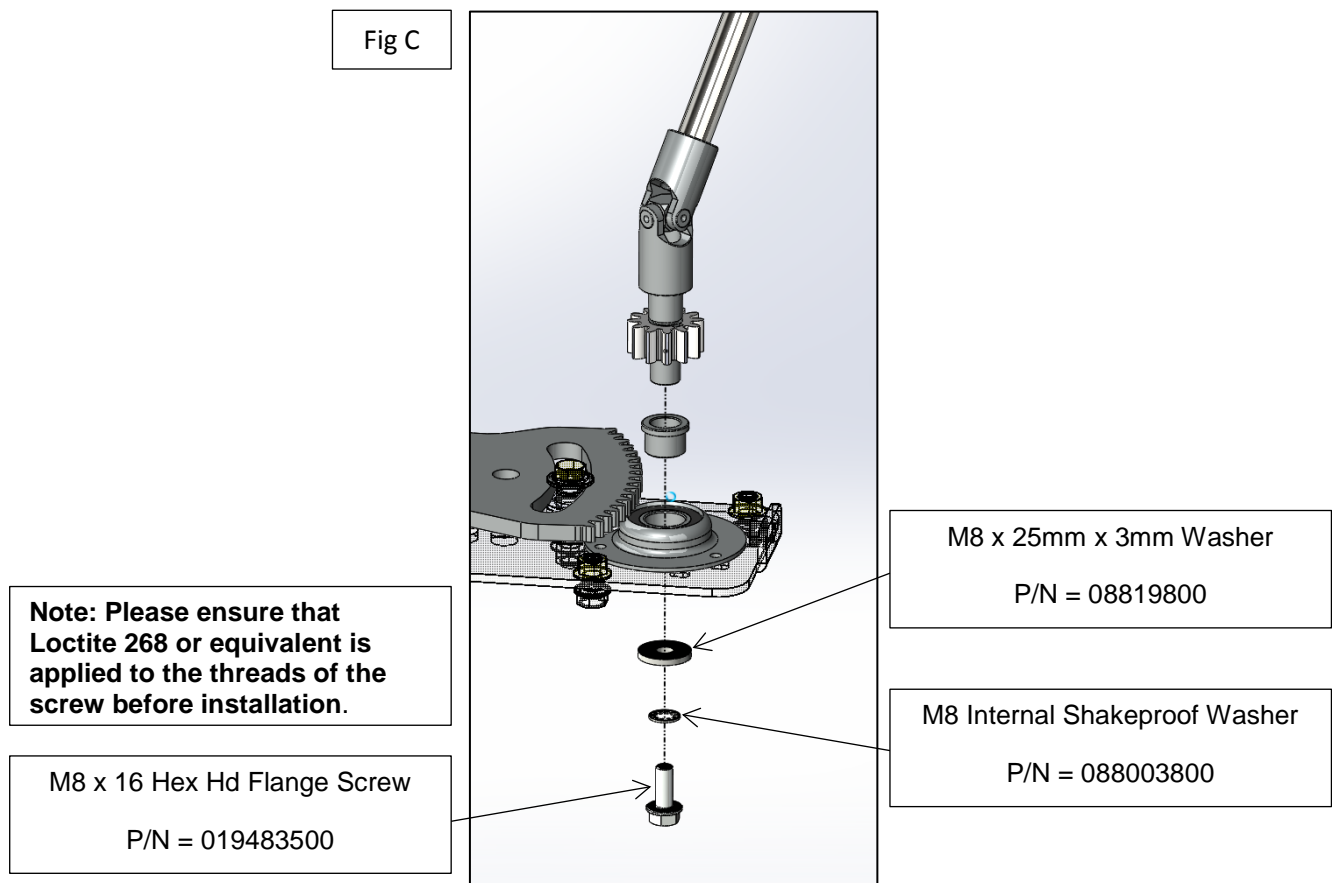

- 6) Tighten the screw to 25Nm using a torque wrench.
- 7) When the fixing check & replacement is complete please check to ensure steering gear and quadrant are adjusted correctly. If the gear has not been removed from the bearing during the previous steps and the steering felt okay then there should be no need to adjust.
- 8) If adjustment is needed then back off the 3 x M5 nuts and bolts shown, remove console panels as access will be required to the top & bottom of the chassis to loosen fixings.

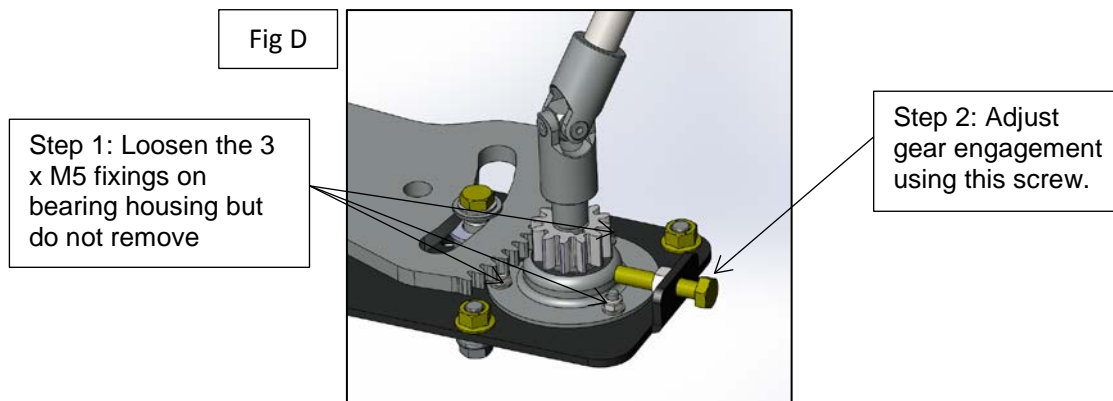

- 9) The screw indicated in fig D is used to adjust the engagement between the gears. Undo the lock nut and it will be free to rotate. Whilst adjusting keeping checking the feel and ensure the gears rotate smoothly. Once the optimum position has been reached where the amount of free play has been minimised then re-tighten the lock nut.
- 10) Re-tighten all 3 M5 fixings and then check again for smooth and free operation of the steering, also ensure full lock is achieved in both directions.
- 11) Replace console covers and fix using quarter turn fasteners.
- 12) Re-connect everything previously removed and return machine to a state so that it can be safely started.
- 13) Check steering function whilst machine is stationary and on flat ground.
- 14) Follow the operator's manual starting procedure and safety checks so that the steering can be checked whilst the machine is moving.