

# COUNTAX™

## **SERVICE BULLETIN**

**15-08-37**

**GROUP:** 08 – GENERAL

**DATE ISSUED:** 15/09/2015

**MODELS:** MK4 C, B, T, F –SERIES AND ECHO TRACTOR MODELS

**OUTLINE:**

- Customers may experience a minor rattling noise from the rear PTO clutch
- In such circumstances please perform the replacement procedure mentioned below.

---

### **RETROFIT KIT NUMBER: 50100081**

Kit contents with part numbers:

Part number	Description	Qty.
549129800	BRKT, PTO CLUTCH STOP RETRO FIT 2015	1
018003200	M8 X 40 HEX BOLT	1
049383700	M8 FLANGE NUT	1
088003700	M8 Washer	2

---

### **PROCEDURE:**

- Please disconnect the battery, disengage the PTO switch and turn off the engine.
- Remove two M8 x 25mm bolts and M8 flange nuts in PTO clutch assembly as shown in Figure 1.
- Assemble the PTO clutch stop bracket(549129800) and M8 x 40 hex bolt/flange nut as shown in Fig.2
- Line up the PTO clutch stop bracket assembly with the existing holes on the Chassis and the Anti-rotation slot in PTO clutch as shown in Figure 3.
- Secure the bracket with existing M8 X25 Flange bolt and M8 Flange nut as shown in Fig. 3.
- Ensure the clutch has both axial and radial free play at minimal level. (refer fig. 4)
- Please reconnect the battery, turn on the Engine and engage the PTO clutch and ensure the clutch is free from rattling noise.



Please contact COUNTAX service department for any further information [warranty@countax.com](mailto:warranty@countax.com)  
Phone: 01844 278800

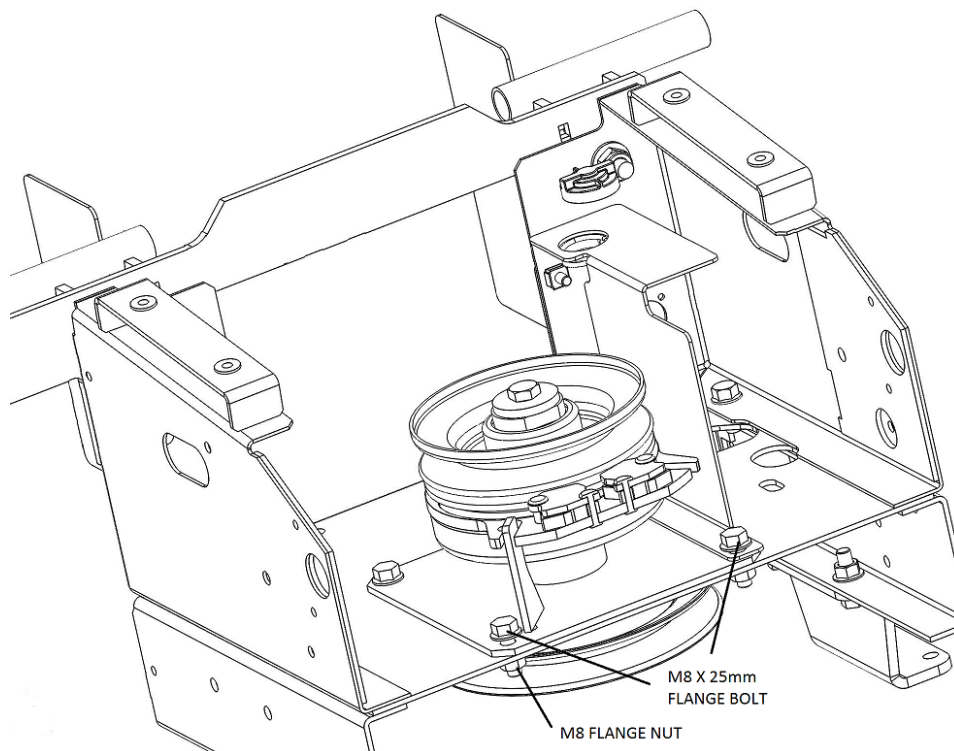

Fig. 1 Remove M8 Flange bolts and nuts.

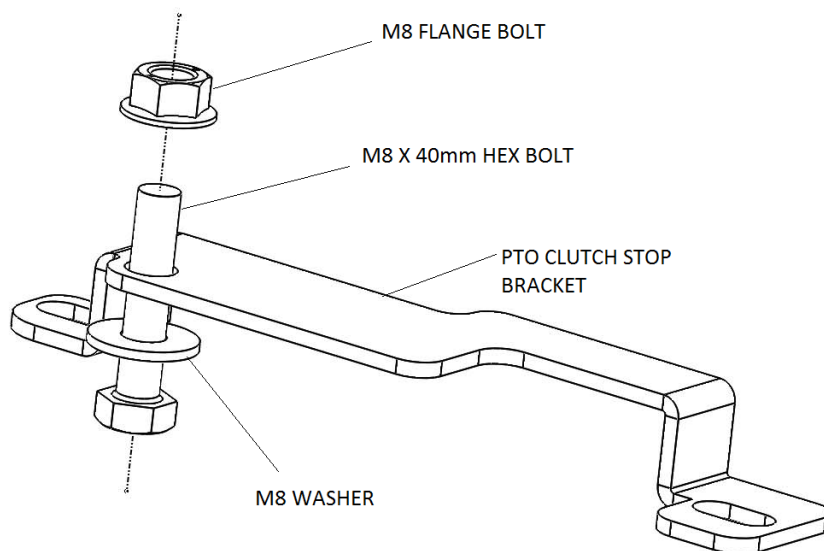

Fig. 2 PTO Clutch stop bracket assembly.



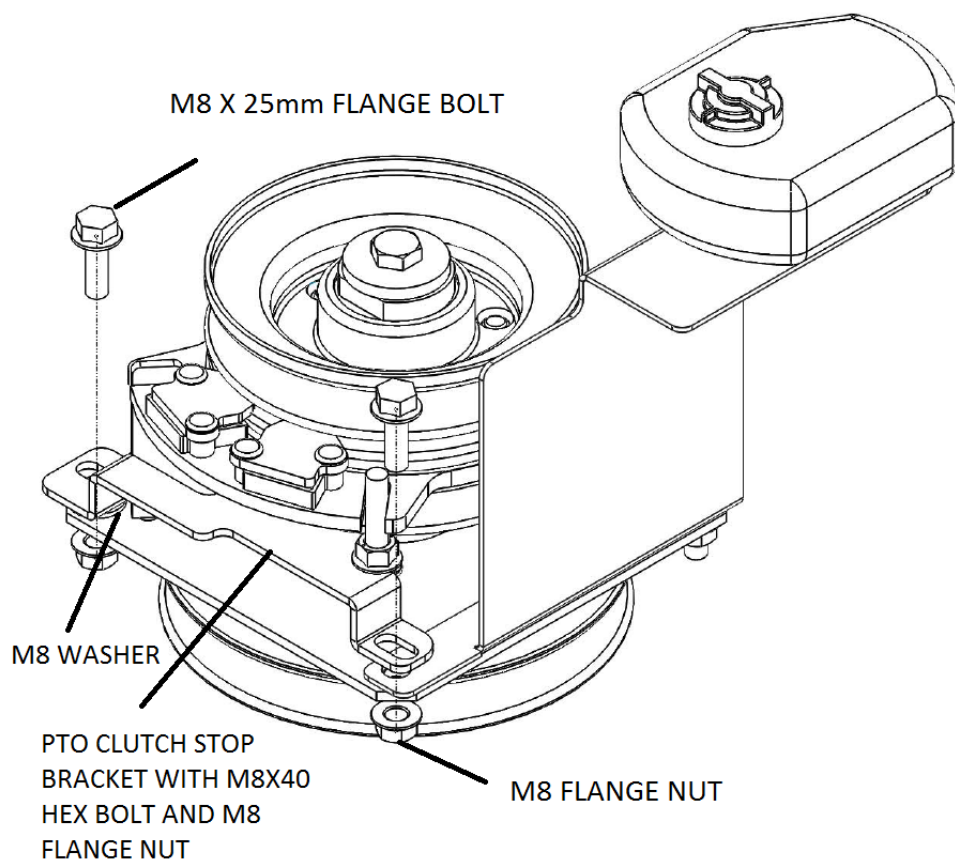

Fig. 3 PTO clutch stop bracket assembly.

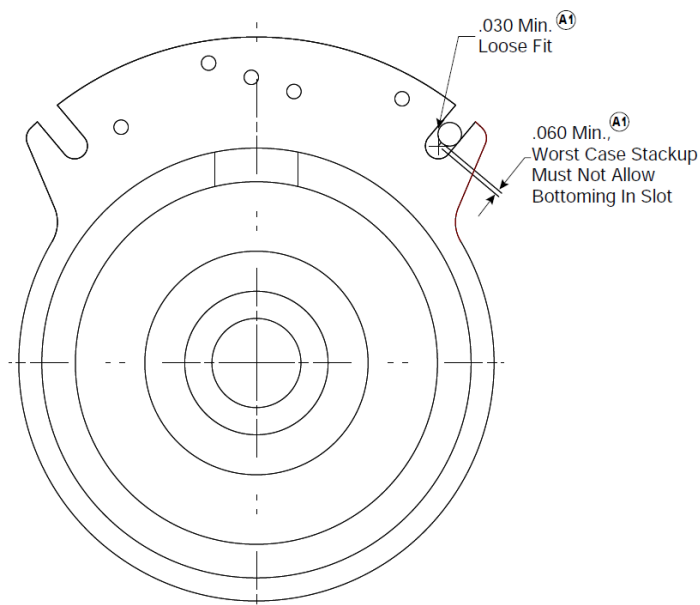

Fig. 4 Anti Rotation reference guide (Dimensions in Inch).

